

AFAD Use in Nebraska

Matt Neemann
State Traffic Engineer

NEBRASKA

Good Life. Great Journey.

DEPARTMENT OF TRANSPORTATION

AFAD Use in Nebraska

- 2023- used in one district (District 7- SW Nebraska)
- Worker injuries/ fatalities
- Expanded use

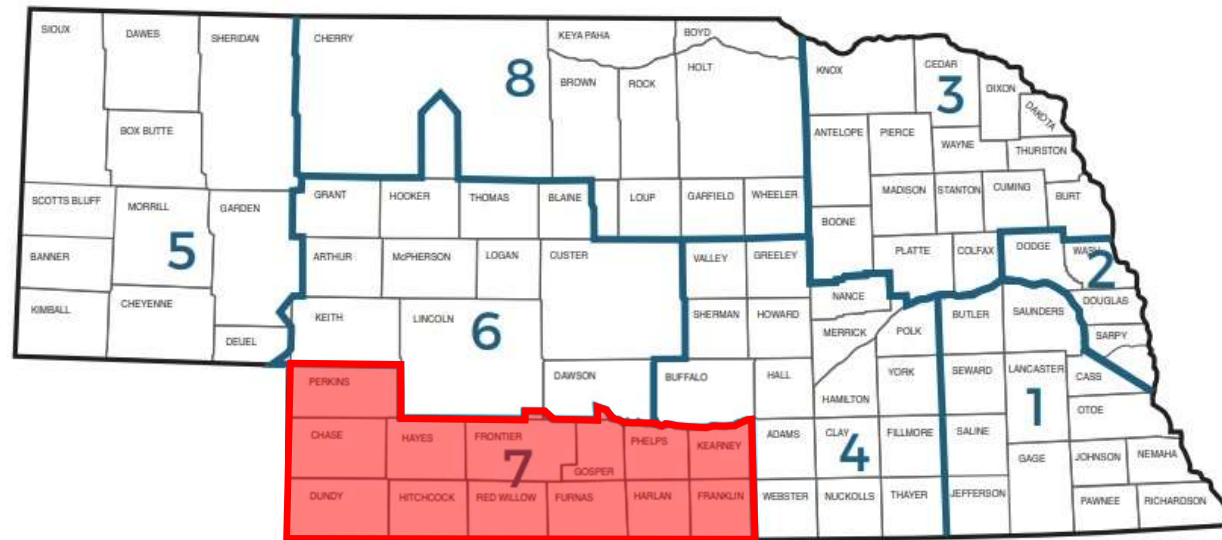

AFAD Usage- District 7

- Rented set of AFAD's from mid April - end of August (2023)
 - Used total of 80 days
 - No incidents involving people driving around the AFAD's
 - No other incidents involving their use.
- Created a very consistent message for the people stopping and driving through our work zones
- Truckers felt that they could be seen sooner, from a farther distance

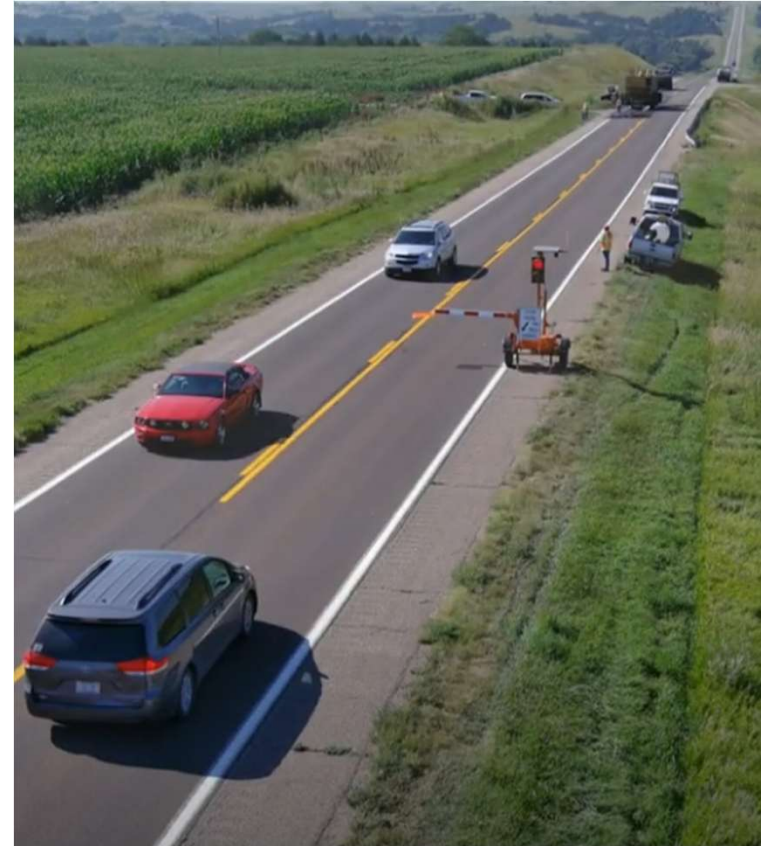

AFAD Usage- District 7

- During a quick moving thunderstorm with lightning, they were able to control traffic from inside a vehicle without putting our flaggers in danger from the lightning.

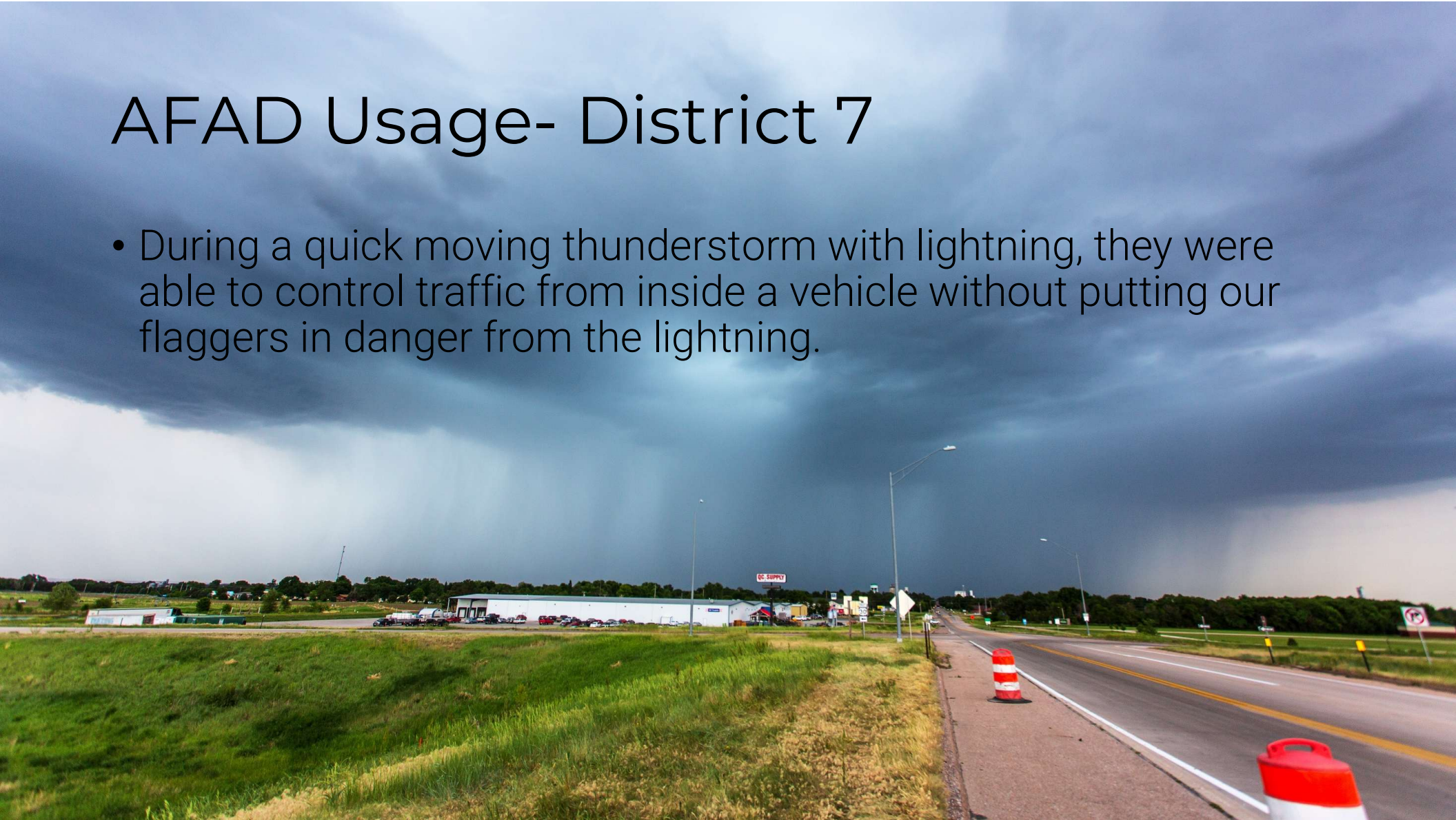

AFAD's

- Procurement contract awarded in March 2024
- 50 AFAD's purchased
 - Delivered in July 2024
- Currently own 100 AFAD's, with 38 on the way.



AFAD's- Construction Projects

Construction Division Directive- July 2024

- Required for all projects beginning with August 2024 letting
- Interim- Beginning 7/1/24, NDOT paid an incentive of \$100 per “flag day” for AFAD use prior to requirement.
 - Added to flagging bid item.

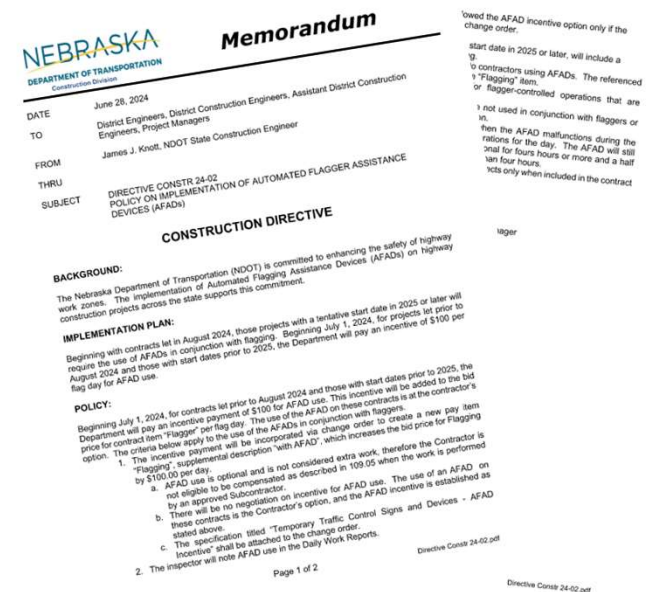

AFAD Plan

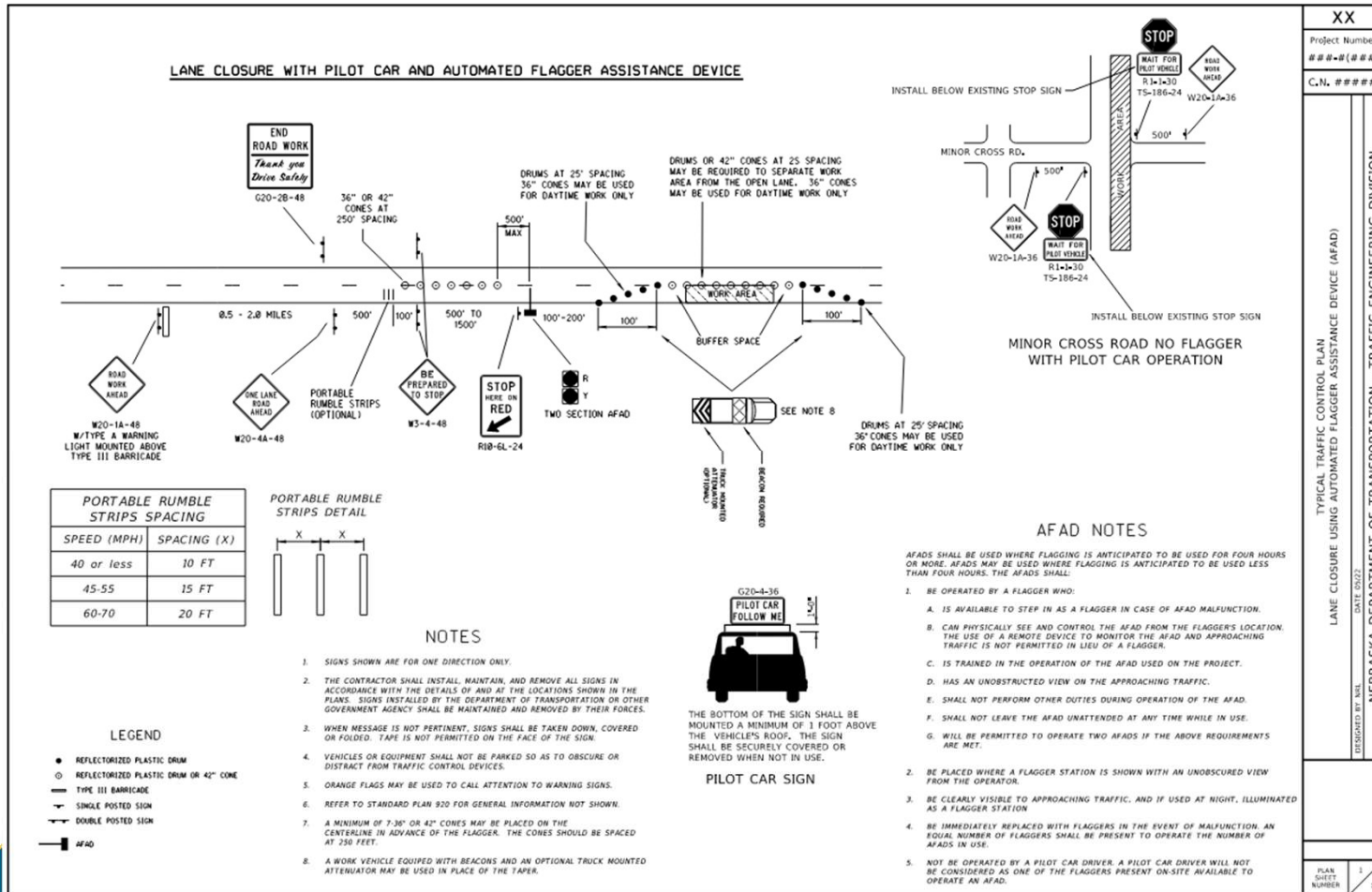

XX

Project Number
###-##-###

C.N. #####

TYPICAL TRAFFIC CONTROL PLAN
LANE CLOSURE USING AUTOMATED FLAGGER ASSISTANCE DEVICE (AFAD)

DESIGNED BY: NAL
DATE: 08/22

NEBRASKA DEPARTMENT OF TRANSPORTATION - TRAFFIC ENGINEERING DIVISION

PLAN SHEET NUMBER
1
1

AFAD Requirements

- AFADs shall be used where flagging is anticipated to be used for four (4) hours or more.
- AFADs may be used where flagging is anticipated to be used less than four hours.



AFAD Rules

The AFAD's shall:

1. Be operated by a flagger who:
 - A. Is available to step in as a flagger in case of AFAD malfunction
 - B. Can physically see and control the AFAD from the flagger's location.
The use of a remote device to monitor the AFAD and approaching traffic is not permitted in lieu of a flagger
 - C. Is trained in the operation of the AFAD used on the project



AFAD Rules

The AFAD's shall:

1. Be operated by a flagger who:
 - D. Has an unobstructed view of the approaching traffic
 - E. Shall not perform other duties during operation of the AFAD
 - F. Shall not leave the AFAD unattended at any time while in use
 - G. Will be permitted to operate two AFAD's if the above requirements are met.
- 

AFAD Rules

The AFAD's shall:

2. Be placed where a flagger station is shown with an unobscured view from the operator
3. Be clearly visible to approaching traffic, and if used at night, illuminated as a flagger station



AFAD Rules



The AFAD's shall:

4. Be immediately replaced with flaggers in the event of malfunction. An equal number of flaggers shall be present to operate the number of AFAD's in use.
5. Not be operated by a pilot car driver. A pilot car driver will not be considered as one of the flaggers present on-site available to operate an AFAD.

AFAD Training



E-LEARNING

Pre-recorded classes split into modules

This highly flexible option allows you to dive into the training you want anytime, anywhere. Obtain certificate upon completion.

- Watch courses on any device with an internet connection.
- Complete a full training program or target modules covering specific topics.
- Learn at your own pace. Start, stop, rewatch. Access the information you want, when you want it.

AFAD Training- Next Steps

- Include in Flagger training
- Best Practices for flagger positioning



AFAD Training- Future Guidance

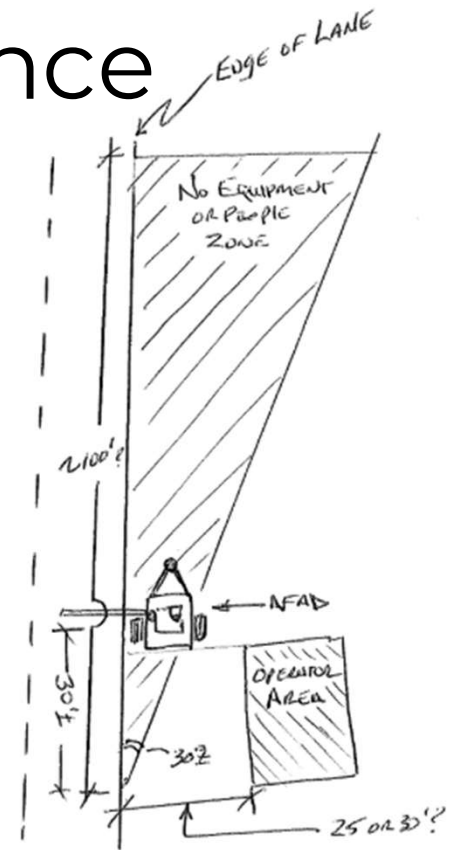
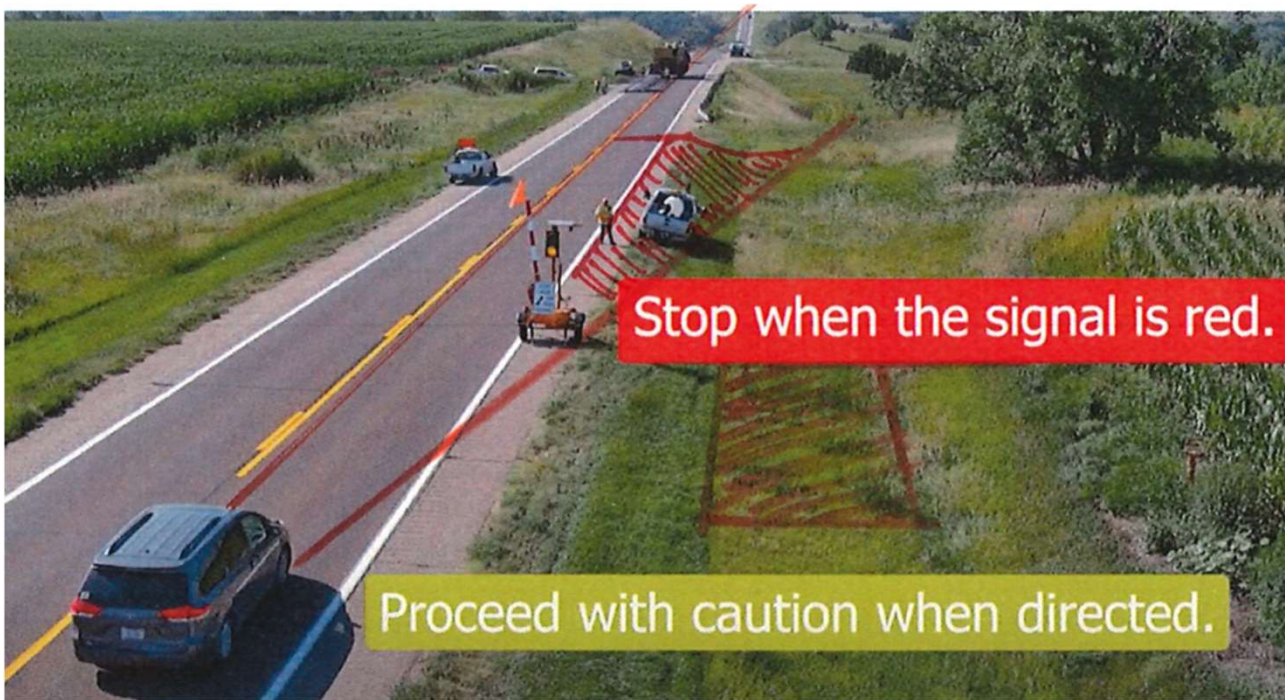

* AFAD SETUP TYPICAL*
(OR AS DIRECTED BY THE ENGINEER)

AFAD Training- Future Guidance

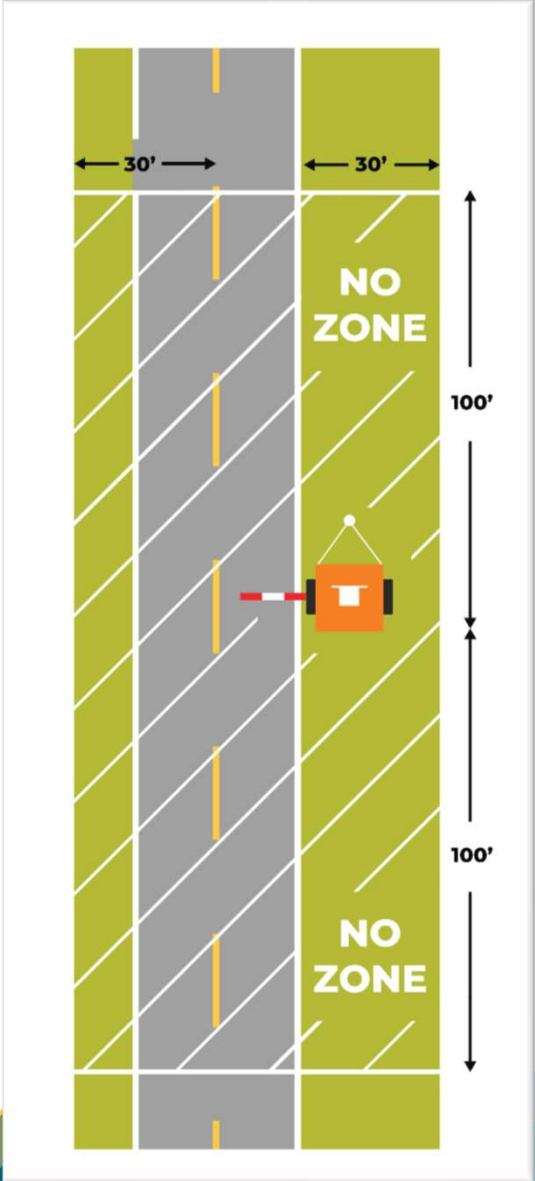

Education and Social Media

Nebraska Department of Transportation Sep 10 · 🌐

Attention drivers! You may be seeing Automated Flagger Assistance Devices (AFADs) in work zones. These devices use bright lights and clear signals to guide drivers, making work zones safer for everyone.

When you see an AFAD:

- ❑ Stop on red
- ❑ Go when signaled
- ❑ Stay alert

Your attention keeps road crews safe!

A graphic with a yellow and blue background. The text "AFAD" is in large blue letters on a yellow background. Below it, "Automated Flagger Assistance Device" is written in white on a blue background. An image of a white AFAD vehicle is shown on a road.

Nebraska DOT
@NebraskaDOT

What is an AFAD?
An Automated Flagger Assistance Device helps manage traffic in short-term lane closures - keeping flaggers safe by letting them operate it remotely.
A reminder for drivers! Treat AFAD's like traditional flaggers, do not drive around them!

YouTube

A video thumbnail with a yellow and blue background. The text "AFAD" is in large blue letters on a yellow background. Below it, "Automated Flagger Assistance Device" is written in white on a blue background. An image of a white AFAD vehicle is shown on a road.

Automated Flagger Assistance Device (AFAD) - Introduction
Automated Flagger Assistance Devices - AFADs - are improving work zone safety by keeping flaggers at a distance from the roadway to control traffic managemen...

4:34 PM · 10 Jun 25 · 2,466 Views

Driver's Education

NEBRASKA
Good Life. Great Journey.
DEPARTMENT OF TRANSPORTATION

Automated Flagger Assistance Devices (AFADs)

The Nebraska Department of Transportation uses Automated Flagger Assistance Devices (AFADs) in work zones on two lane roadways. They improve work zone safety by keeping flaggers at a distance from the roadway to control traffic in a short-term closure.

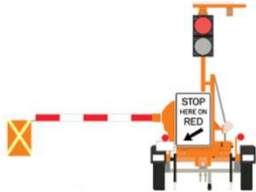

STOP

- Stop when the light is red and the arm is down.



PROCEED

- Proceed with caution when the light is yellow and the arm has lifted.
- Follow a pilot car (if used) when yellow.

Don't bypass the AFAD. You may put workers and other drivers at risk.

NEBRASKA
Good Life. Great Journey.
DEPARTMENT OF TRANSPORTATION

Dispositivos Automáticos de Asistencia para la Señalización con Banderas (AFADs)

El Departamento de Transporte de Nebraska utiliza dispositivos automáticos de asistencia para la señalización con banderas (AFADs, por sus siglas en inglés) en zonas de trabajo en vías de dos carriles. Estos mejoran la seguridad en la zona de trabajo al mantener los banderilleros a una distancia de la vía para controlar el tránsito cuando hay un cierre de corto plazo.

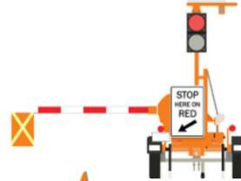

ALTO

- Deténgase cuando la luz esté roja y el brazo esté abajo.



PROCEDA

- Avance con precaución cuando la luz esté amarilla y el brazo esté levantado.
- Siga al vehículo guía (si se utiliza) cuando el semáforo esté en amarillo.

No maneje alrededor del dispositivo AFAD. Podría poner en peligro a los trabajadores y a otros conductores.

NEBRASKA
Good Life. Great Journey.
DEPARTMENT OF TRANSPORTATION

أجهزة المساعدة الآلية لمنظمي حركة المرور (AFADs)

تستخدم وزارة النقل في ولاية نبراسكا أجهزة مساعدة الآلية لمنظمي حركة المرور، لتنظيم حركة المرور في مناطق أعمال الطرق ذات المسارين. وهذه الأجهزة تساعد على تأمين السلامة في مناطق العمل، لأنها تسمح لمنظمي حركة المرور بالوقوف بعيداً عن الطريق بينما يضبط الجهاز حركة السيارات.

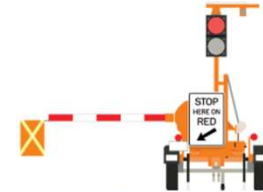

قف

- يجب عليك التوقف عندما تشاهد الضوء الأحمر ويكون الذراع منخفضاً



إستمر بالسير

- تابع السير بحذر عندما يكون الضوء أصفراً ويكون الذراع مرفوعاً
- إذا كانت هناك سيارة تقودكم على الطريق، فيجب إتباعها عندما يكون اللون أصفراً

لا تحاول الإلتفاف حول أجهزة تنظيم حركة المرور، لأنك بذلك قد تعرض حياة العمال والسواق إلى الخطر

Safety

- Flaggers were asked, “do you feel safer while doing your job with the AFAD?”
- 100% said YES



Questions?

Matt Neemann, P.E.

State Traffic Engineer

Nebraska Department of Transportation

matt.neemann@nebraska.gov

(402)479-4594

